



YOUR WOOD CARE RESOURCE



Satterwhite Log Homes



Honest Abe Log Homes



Tomahawk Log & Country Homes



Sand Creek Post and Beam



Hearthstone Homes



StoneMill Log & Timber Homes

Since 1981, Perma-Chink Systems, Inc. has developed a comprehensive system of products designed for the unique needs of wood homes. Our finishes, sealants, restoration products and preservatives are designed to work together covering all phases of home beautification, protection, and maintenance.

We take pride in the enhanced natural beauty our products offer the homeowner. Our products look better, last longer and are easier to use than anything on the market today.

Our System of Products has dramatically reduced the expense and effort of maintaining a natural wood home. Superior products and an unparalleled commitment to customer service have made Perma-Chink Systems the industry leader in the appearance and maintenance of natural wood homes.

Quality Products

For over three decades Perma-Chink Systems, Inc. has manufactured the highest quality products and supplies specifically formulated for natural wood homes. We are committed to using only the best ingredients and most advanced technology available. Thousands of customer testimonials confirm that the quality of our products have made us an industry leader in the natural wood home market.

Customer Service

Our commitment to customer service begins the first time you give us a call. During business hours, a product support specialist, not a machine, will greet you. Our team members are highly trained to assist you in all aspects of beautifying and maintaining your home. Because we are the manufacturer, we can answer even the most technical questions regarding our **System of Products**. We will give you the guidance, information and product samples necessary to make informed decisions about your project. We can also help you find friendly professional contractors in your area, if necessary.

Experience

Perma-Chink Systems, Inc. is a systems company. No other log home related company offers the broad spectrum of products that we do. We have put together a family of products that work together and complement each other. Our technical department has spent many years developing products that work, are safe to use and are compatible with one another. That is why it is so important to use our system rather than individually purchasing one or two of our products. We have stayed abreast of the latest polymer technologies resulting in better performance, increased beauty and easier application of our systems which has kept us ahead of our competitors.

Locations

You can visit any of our fully stocked retail stores or distributor outlets located across the United States, Canada, and Europe for sales and product support. You may also call any of our toll-free numbers or contact us via our website, www.permachink.com. We will arrange prompt delivery to your doorstep or job site.

- A nationwide network of retail outlets
- Ordering and technical assistance via phone or internet
- Professional, experienced specialists
- Natural wood homes are our only business
- Secure and convenient internet shopping
- MADE in the USA



Connect with us on



1-800-548-3554

www.permachink.com

Table of Contents

Sequence of Events	3
Exterior Stains and Finishes	
Lifeline Ultra-7	5
Why Use Lifeline?	6
Lifeline Ultra-2	7
Lifeline Accents	9
Lifeline Exterior	10
Log End Seal	11
UV Boost	11
Prelude	11
Lifeline Advance	13
Deck Defense	15
Interior Stains and Finishes	
Lifeline Interior	17
Lifeline Acrylic	19
Sure Shine	21
Chinking and Specialty Sealants	
Sealants Overview	22
Energy Seal	23
Perma-Chink	24,25
Chink-Paint	27
Check Mate 2	29
Woodsmen	30
Log Home Gasket Tape	30
Application Tools	29,33
Grip Strip	31
Backer Rod	31
Log Gap Cap	31
Sealing Around Windows & Doors	33
Preservatives	
Armor-Guard	34
Cobra Rods	34
Shell-Guard Concentrate	34
Shell-Guard RTU	35
Wood Cleaners and Strippers	
Log Wash	37
Cedar Wash	37
Oxcon	38
Wood ReNew	38
pH Strips	38
StripIt	39
S-100	39
Wood Restoration Epoxies	
M-Balm and E-Wood	40
Epoxy Paste	41
Fasteners	
Log Boss	42
Wood Shapers	
Blaster Buddy	43
Osborn, Sanding Disks	43
Stucco & Plaster	
EuroPlast and EuroSeal	44
Good to Know	
Calculating Sq. Ft.	45
Inspection Checklist	46
Questions & Answers	47
Locations	49

Log and Timber Home Manufacturers

Our Partners

They Build - We Finish

START HERE TO MAKE YOUR LOG or TIMBER HOME DREAM COME TRUE!



1-800-777-7288
www.satterwhite-log-homes.com



1-800-231-3695
www.honestabe.com



1-800-247-4442
www.hearthstonehomes.com



1-800-438-8274
www.stonemill.com



1-800-270-5025
www.goldeneagleloghomes.com



1-888-988-7463
www.woodhavenlog.com



1-406-363-5680
www.rockymountainloghomes.com



1-800-726-0708
www.alhloghomes.com



1-330-359-5726
www.fairviewloghomes.net



1-888-563-3275
www.blueridgelogcabins.com



1-888-675-3678
www.elohomes.com



1-866-258-4818
www.gostrongwood.com



1-207-757-8278
www.katahdincedarloghomes.com



1-802-755-6298
www.goodridgelumber.com



1-541-385-6006
www.swissmtloghomes.com



1-530-899-0680
www.sierralogandtimber.com



1-800-326-8045
www.battlecreekloghomes.com



1-540-337-0033
www.blueridgeloghome.com



1-800-308-7505
www.coventryloghomes.com



1-352-529-2070
www.crackerstyleloghomes.com



1-800-818-9971
www.woodworkersshoppe.com



1-866-436-2522
www.ksmloghomes.com

www.permachink.com

1-800-548-3554



Sequence of Events

Exterior

Sequence of Events When Restoring an Existing Home

1. Repair any areas of log rot. If using *Log End Seal* sand the log ends with 60-80 grit sandpaper.
2. *Energy Seal* around windows, doors, butt joints, and between logs. Allow to cure one week. This will help prevent water or blasting media from getting inside the home.
3. Clean or strip off the old finish. Rinse thoroughly; use pH strips to ensure ample rinsing has been done. Allow the wood to completely dry. If media blasted, wash surface with *Log Wash* solution.
4. Apply a Borate treatment (recommended). Allow to dry according to label recommendations.
5. If more than 7 days have passed since step 3 or 4, wash down surface with a *Log Wash* solution. Rinse well and allow wood to completely dry.
6. Apply *Check Mate 2* to upward facing checks. Allow *Check Mate 2* to cure at least 3 hours before staining.
7. If blasted, apply *Prelude* clear wood primer before *Lifeline* stain. If blasting was not done you can start applying *Lifeline* stain according to label guidelines.
8. Repair chinking or apply *Chink-Paint* if applicable.
9. Apply *Log End Seal*, if desired.
10. Apply *Lifeline Advance* gloss or satin topcoat.

Sequence of Events for New Construction

1. Sanding with 60-80 grit sandpaper is recommended for decking, or if using *Log End Seal* on the log ends.
2. Clean home to remove dirt, brown stain, and mill glaze. If gray wood or mill glaze is present use *Wood ReNew*. If gray wood and mill glaze are not present use *Log Wash*. Rinse thoroughly and allow wood to completely dry.
3. Apply a Borate treatment (recommended). Allow to dry according to label recommendations.
4. Apply *Energy Seal* around windows, doors, butt joints, and between logs. Apply *Check Mate 2* to upward facing checks. Allow to cure at least 3 hours.
5. If more than 7 days have passed since step 2 or 3, wash down surface with a *Log Wash* solution. Rinse well and allow wood to completely dry.
6. Apply *Lifeline* stain according to label guidelines.
7. Chink home if applicable.
8. Apply *Log End Seal* if desired.
9. Apply *Lifeline Advance* gloss or satin topcoat.



Training Seminars



In-House Workshops



Personal Web Training



Professional Referrals

Wood Stain and Finishes

Exterior



HONEST ABE LOG HOMES

Color in this photo closely represents Lifeline Ultra-7 Smoke. Actual results will vary. Contact Perma-Chink Systems for samples.

Wood Stain and Finishes

Exterior

Lifeline Ultra-7™

Our Highest Performance Transparent Wood Stain for Walls

Lifeline Ultra-7 is our highest quality wood stain enhanced with an advanced polymer resin that delivers sophisticated color, unmatched durability and maximum coverage.

Appearance:

By choosing *Lifeline Ultra-7*, you are ensuring that the finish will look as beautiful years after application as it did the second day it was applied.

Longevity:

After multiple exposure tests in harsh-weather areas across the country, *Lifeline Ultra-7* stands out as THE top-of-the-line, long-lasting finish.

Value:

There is no doubt that *Lifeline Ultra-7* will save you time and money in the long run. Lasting longer equates to less labor expense over the life of the finish.

Environment:

Low VOC, water-based *Lifeline Ultra-7* meets and exceeds all standards and environmental requirements in North America.

- High coverage rate
- Excellent UV protection
- Easy maintenance procedures
- Breathable film allows unseasoned logs to dry out
- For walls and other vertical surfaces
- Comes with a 5-year limited warranty
- Clear coat with *Lifeline Advance* to complete the system
- Custom colors available

★ New Colors

Application techniques, wood species and other factors will affect the actual color when finished. We supply samples for evaluation on your specific wood.



Eucalyptus, #390



Caramel, #325



Cedar, #385



Oak, #332



Bronze, #374



Chestnut, #365



Almond, #345



Rustic Gray, #372



Smoke, #363

Surface Preparation:

Must be applied to clean, dry surface.

of Coats:

One coat application.
Topcoat with Lifeline Advance Gloss or Satin Clear Topcoat.

Application Rates:

250-350 sq. ft. per gallon depending on the porosity of the wood.

Application Temperature:

40° F to 90° F

Application Methods:

Airless sprayer with back-brushing to ensure even coverage OR all by brush. Stir before and frequently during application.

Drying Time:

Dry to the touch in 4 to 6 hours.
Cures in 72 hours.

Clean up:

Soap and water.

Packaging:

1-gallon container.
5-gallon pail.
Samples available.

Storage/Shelf Life:

Freeze/thaw stable.
3 years.



Wood Stain and Finishes

Exterior & Interior

Why Use *Lifeline*™ Stain and Clear Coats?

The Systems Approach to Log Home Care

Appearance

Lifeline stain highlights the grain and texture of your wood. *Lifeline* clear coats add depth to the surface and offer you a choice of just how much gloss you would like on the finish. Your house looks as good as a fine piece of furniture.

Longevity

Perma-Chink Systems has tested over 60 different finishes from more than 20 manufacturers. *Lifeline Ultra-2* with *Lifeline Advance* clear topcoat has outlasted every one of those finishes in side-by-side comparisons on test walls. Our formulations use components that are individually specialized for their function. Among many other differences, our clear-coats are not just clear *Lifeline*; they are a completely different formulation that performs better than a simple clear version of the color coat.



Value

No other stain gives you more for your money. All *Lifeline* finishes are formulated to provide maximum coverage to lower your cost for the job as compared to common stains that require much more material for your job. Remember to compare coverage rates to make an accurate comparison for your material costs.

Cost Over 10-year Period

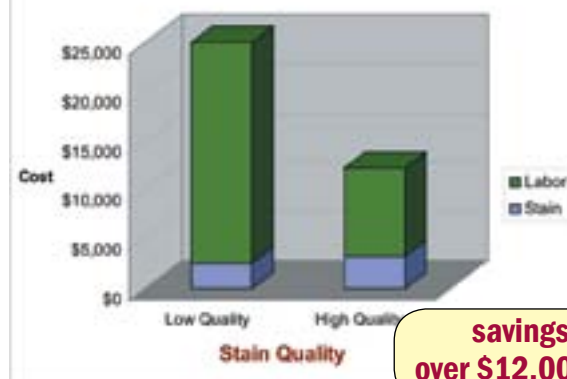

Do the math and get the greatest value for your time!

It is no surprise that high-quality products from Perma-Chink Systems' extensive collection of exterior stains and finishes will result in spending less time and money protecting and maintaining your log home over the years.

Environment

Lifeline has always been formulated to be gentle on the environment. It is water-based, extremely low VOC and has low odor during drying. After it is dry, it has no odor, so it is demanded by many of our customers who have chemical sensitivities. Your tools clean up with just soap and water. It just cannot get any easier.

Wood Stain and Finishes

Exterior

Lifeline Ultra-2™

Our Best Selling, Highest Performance Exterior Wall Stain

No other transparent finish system lasts as long as *Lifeline Ultra-2* with a clear topcoat of *Lifeline Advance*. It is so durable that it is covered by a 5-year limited warranty. This advanced waterborne formula enriches the look of natural wood grain and protects against damaging UV from the sun.

Homeowners and contractors appreciate just how easy it is to apply with an airless sprayer or brush. Remember – not all waterborne stains are created equal. Get a free sample of *Lifeline Ultra-2* and see for yourself.

- Unparalleled UV protection
- Lowest maintenance of any exterior finish
- Breathable film allows unseasoned logs to dry out
- High coverage rates
- Superior color retention
- Environmentally friendly
- Custom colors available



StoneMill Log & Timber Homes

Surface Preparation:
Must be applied to clean, dry surface.

Application Rates:
1st coat - 350-450 sq.ft. per gallon depending on the porosity of the wood.

2nd coat - 600-800 sq.ft. per gallon.

Application Temperature:
40° F to 90° F

Application Methods:
Airless sprayer with back-brushing to ensure even coverage OR all by brush. Stir before and frequently during application.

of Coats:
Two-coat application. Topcoat with Lifeline Advance Gloss or Satin Clear Topcoat.

Drying Time:
Dry to the touch in 2 to 4 hours. Cures in 72 hours.

Clean up:
Soap and water.

Packaging:
1-gallon container. 5-gallon pail. Samples available.

Storage/Shelf Life:
Freeze/thaw stable. 3 years.

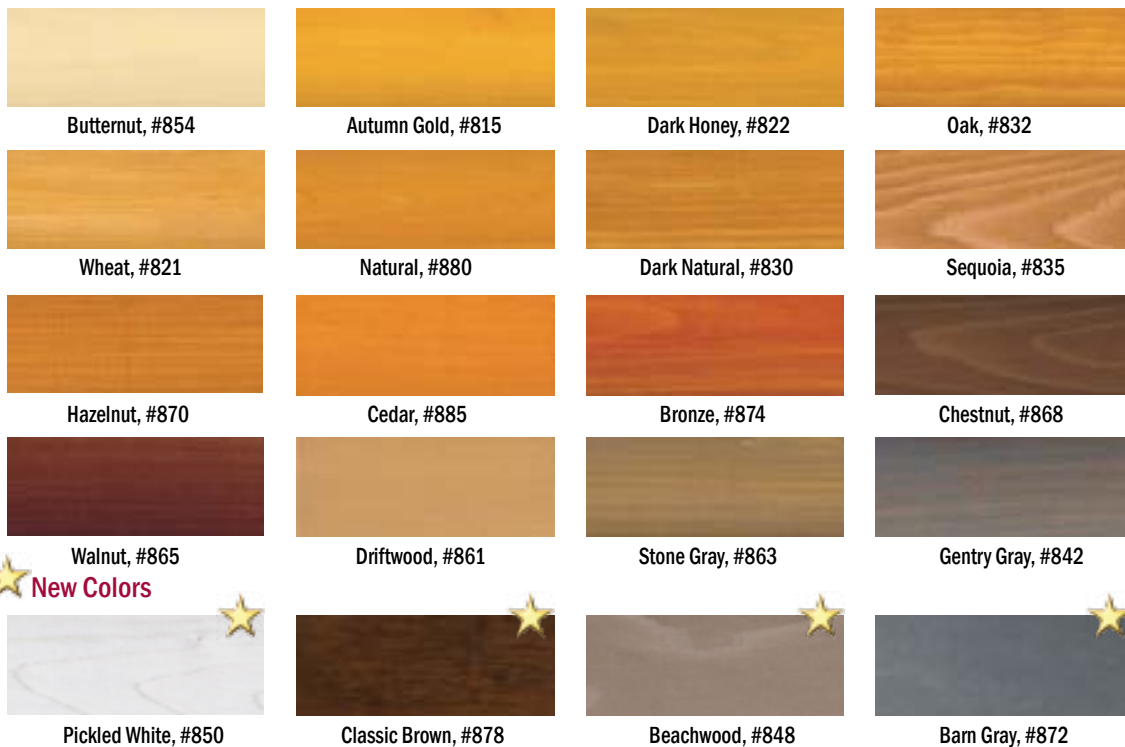

★ New Colors ★



Application techniques, wood species and other factors will affect the actual color when finished. We supply samples for evaluation on your specific wood.



1-800-548-3554

www.permachink.com

Wood Stain and Finishes

Exterior & Interior



GOLDEN EAGLE LOG HOMES

Color in this photo closely represents Lifeline Accents Black Walnut. Actual results will vary. Contact Perma-Chink Systems for samples.

Wood Stain and Finishes

Exterior & Interior

Lifeline Accents™

Inspired Collection of Transparent Stains for Interiors and Exteriors

Lifeline Accents is our exceptional two-coat color finish developed to make your home look fashionable. *Lifeline Accents* was influenced by global trends which encouraged us to provide our customers with exciting new colors and style.

The exceptional colors create a wonderful accent for your wood trim, interior and exterior walls, millwork, timber, furniture and other wood elements of your home.



Hearthstone Homes

- High coverage rate
- Clear coat with *Lifeline Advance* to complete the system for exterior and *Lifeline Acrylic Gloss/Satin* or *Sure Shine Gloss/Satin* for interior
- Excellent UV protection
- Low maintenance
- Long-lasting color retention
- Custom colors available



Pickled White, #762



Evergreen, #770



Spruce, #766



Midnight, #714



Espresso, #746



Jade, #774



Fern, #782



Azure, #718



Bordeaux, #738



Black Walnut, #742



Garnet, #726



Cinnabar, #730



Barn Red, #734



Newport, #722



Sand, #754



Umber, #758



Forest, #778



Charcoal, #750

Surface Preparation:
Must be applied to clean, dry surface.

Application Rates:
1st coat - 350-450 sq. ft. per gallon depending on the porosity of the wood.
2nd coat - 600-800 sq. ft. per gallon.

Application Temperature:
40° F to 90° F

Application Methods:
Airless sprayer with back-brushing to ensure even coverage OR all by brush. Stir before and frequently during application.

of Coats:
For Exterior
Two-coat application. Topcoat with Lifeline Advance Gloss or Satin Clear Topcoat.
For Interior
One or two coat application. Topcoat with Lifeline Acrylic Gloss/Satin Clear Topcoat or Sure Shine Gloss/Satin.

Drying Time:
Dry to the touch in 2 to 4 hours. Cures in 72 hours.

Clean up:
Soap and water.

Packaging:
1-gallon container. Samples available.

Storage/Shelf Life:
Freeze/thaw stable. 3 years.



Application techniques, wood species and other factors will affect the actual color when finished. We supply samples for evaluation on your specific wood.

Wood Stain and Finishes

Exterior

Lifeline Exterior™

Our Value Priced Exterior Wall Stain

Our original exterior wall formula has been updated and improved for over 20 years. *Lifeline Exterior* forms a thin film at the surface of logs where the protection is needed.

Its breathability and flexibility allows logs to go through seasonal expansion and contraction while drying out to their core. Apply a clear topcoat of *Lifeline Advance* to maximize durability and minimize maintenance cost and labor.

- Clear coat with *Lifeline Advance* to complete the system
- Excellent UV protection
- Easy application and maintenance
- Breathable film allows logs to dry out
- High coverage rates
- Long-lasting color retention
- Dries fast to allow two-coat application the same day
- Environmentally friendly
- Custom colors available

Surface Preparation:

Must be applied to clean, dry surface.

Application Rates:

1st coat - 350-450 sq.ft. per gallon depending upon the porosity of the wood.

2nd coat - 600-800 sq.ft. per gallon.

Application Temperature:

40° F to 90° F

Application Methods:

Airless sprayer with back-brushing to ensure even coverage OR all by brush. Stir before and frequently during application.

of Coats:

Two coats application.
Topcoat with *Lifeline Advance* Gloss or Satin Clear Topcoat.

Drying Time:

Dry to the touch in 2 to 4 hours.
Cures in 72 hours.

Clean up:

Soap and water.

Packaging:

1-gallon container.
5-gallon pail.
Samples available.

Storage/Shelf Life:

Freeze/thaw stable.
3 years.



Butternut #154



Dark Honey #122



Dark Natural #130



Hazelnut #170



Cinnamon #174



Bronze #175



Walnut #165



Driftwood #161



Stone Gray #163



Gentry Gray #142

Application techniques, wood species and other factors will affect the actual color when finished. We supply samples for evaluation on your specific wood.



Wood Stain and Finishes

Exterior

Log End Seal™

Protect Exposed End-Grain from the Elements

Surface Preparation:

Must be applied to clean, dry surface.
Sand log ends before applying Lifeline stain.

Application Rates:

30 to 40 sq.ft. per gallon. One gallon will coat approx. 180 six inch diameter log ends or 100 eight inch diameter log ends.

Application Temperature:
40° F to 90° F

Application Methods:
Paint pad or sponge.
Short bristled brush.

of Coats:
One coat application.

Drying Time:
Dry to the touch in 2 to 4 hours.

Clean up:
Soap and water.

Packaging:
1-gallon container.

Storage/Shelf Life:
DO NOT FREEZE!
3 years.

The end-grain of wood is particularly vulnerable to sun, rain, snow and ice, which can lead to excessive cracks and checks. End-grain can also act like tiny straws, drawing excessive moisture into the wood. *Log End Seal* provides a durable, water-repellent barrier against these problems before they begin.



Goes on white and dries clear



Prelude™

A Clear Primer for Porous Wood Surfaces

One coat of *Prelude* clear wood primer seals porous or rough wood surfaces. *Prelude* is highly recommended following the use of blast media to remove old finishes, because this removal process opens the wood pores, creating a challenge in getting an even finish color during staining. *Prelude* provides the foundation to restore consistent color and a uniform finished appearance with *Lifeline* stains.

Prelude clear wood primer contains *UV Boost* for additional UV protection. *Prelude* is a primer and should never be used as a final finish.



Not sealed with Prelude

Sealed with Prelude

**Surface Preparation:**

Must be applied to clean, dry surface.

Application Rates:

200 to 400 sq.ft. per gallon depending on the porosity of the wood.

Application Temperature:
40° F to 90° F

Application Methods:

Airless sprayer with back-brushing to ensure even coverage OR all by brush. Stir before and frequently during application.

of Coats:
One coat application.

Drying Time:
Dry to the touch in 2 to 4 hours.
Cures in 72 hours.

Clean up:
Soap and water.

Packaging:
1-gallon container.
5-gallon pail.
Samples available.

Storage/Shelf Life:
Freeze/thaw stable.
3 years.

UV Boost™

Additional Protection for High Sun Exposure Areas

The addition of *UV Boost* to the first coat of any of our other finishes imparts additional protection against fading and graying. It is especially useful in interior finishes to reduce the “picture frame” effect on walls and carpeted floors. Since *UV Boost* must be in contact with bare wood for it to be effective, it only needs to be added to the first coat of finish.

Note: *Lifeline Ultra-2*, *Lifeline Ultra-7* and *Prelude* already contain *UV Boost*.

**Container Sizes**

For adding to one gallon and five gallons of finish.

Wood Stain and Finishes

Exterior



HEARTHSTONE HOMES

Color in this photo closely represents Lifeline Exterior Driftwood. Actual results will vary. Contact Perma-Chink Systems for samples.

Wood Stain and Finishes

Exterior

Lifeline Advance™

Gloss/Satin

Clear Topcoat - the Second Component of Our Exterior Finish System

Lifeline Advance works just like the clear-coat on your car to protect the color coat underneath. It extends the life of the finish system while adding depth and highlights to the appearance. It makes your exterior walls easier to keep clean.

Lifeline Advance has the right permeability to keep the film breathable while repelling water.

Lifeline Advance is the second component in our exterior wall finish system that includes a limited warranty when used with *Lifeline Ultra-2* or *Lifeline Ultra-7*.

- Satin or Gloss finish
- Simplifies and reduces maintenance of your exterior finish
- Significantly extends the life of the finish system
- Adds depth and luster to appearance
- Extremely high coverage
- Breathable to allow logs to dry out
- Environmentally friendly
- Only for use over *Lifeline Ultra-2*, *Lifeline Ultra-7*, *Lifeline Exterior* or *Lifeline Accents*

STAY CLEAN™

Add an extra measure of protection against surface mold by adding *Stay Clean* to the topcoat.



Blue Ridge Log Cabins



Satin

Gloss



Ward Log Homes

Surface Preparation:
Must be applied to clean, dry surface.

Application Rates:
500-700 sq.ft. per gallon for rough surfaces.
600-800 sq.ft. per gallon for smooth surfaces.

Application Temperature:
40° F to 90° F

Application Methods:
Airless sprayer with back-brushing to ensure even coverage OR all by brush. Stir before and frequently during application.

of Coats:
One coat application over LIFELINE stain.

Drying Time:
Dry to the touch in 2 to 4 hours.
Cures in 72 hours.

Clean up:
Soap and water.

Packaging:
1-gallon container.
5-gallon pail.
Samples available.

Storage/Shelf Life:
Freeze/thaw stable.
3 years.



Wood Stain and Finishes

Exterior



Wood Stain and Finishes

Exterior

Deck Defense™ **Improved**

Exterior Deck Finish

Deck Defense has been reengineered with a new formula for better performance, longer life, and easier application. Although it is a totally waterborne product, it has penetrating properties like oil finishes, but unlike oil-based products, it hardens into a lattice, supporting and strengthening the natural cellulosic fibers to protect from the inside out - not just on the surface. Homeowners can feel secure in the knowledge that their investment is protected from the damaging effects of wind, sun and water.

Normal maintenance has also been made easier, as there will be no need to strip off the old *Deck Defense* prior to re-application, as it will not flake or peel when properly applied. Just clean the surface to remove any dirt or contaminants, allow the deck to fully dry, then apply your maintenance coat.

- Excellent weather resistance
- Excellent color retention
- Allows texture and grain to show
- Low odor and VOC
- Contains trans-oxide pigment
- Easy application
- Easy soap and water clean-up
- Complimentary *Lifeline* colors and custom colors available



Surface Preparation:
Must be applied to clean, dry surface.

Application Rates:
One coat - 175-250 sq.ft. per gallon depending on the porosity of the wood. Please refer to product label for application instructions.

Application Temperature:
40° F to 95° F

Application Methods:
Airless sprayer.
Pump up sprayer.
Brush.
Roller.
Pads.

of Coats:
Up to two coats (refer to label for specific directions for two coat application).

Drying Time:
Dry to the touch in 15 minutes.
Tack free in 30 minutes.

Clean up:
Soap and water.

Packaging:
1-gallon container.
5-gallon pail.
Samples available.

Storage/Shelf Life:
Freeze/thaw stable.
1 year.



Harvest Wheat #1920



Redwood #1940



Weathered Gray #1960



Honey Maple #1930



Hickory #1950

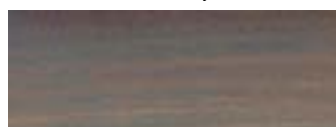

Gentry Gray #1942



Barn Gray #1972

Application techniques, wood species and other factors will affect the actual color when finished. We supply samples for evaluation on your specific wood.



Wood Stain and Finishes

Interior



PIONEER LOG SYSTEMS

Color in this photo represents Lifeline Interior Stone Gray. Contact Perma-Chink Systems for samples.

Enhance the beauty of all your interior wood and seal out household odors and contaminants. *Lifeline Interior* can be used as a color coat or sealing coat on walls when you want to apply an interior clear-coat for additional protection or luster. Interior finishes make log walls easy to clean.

Lifeline Interior breathes to allow trapped moisture to evaporate from logs.

To reduce the “picture frame effect” in sun-exposed locations, add *UV Boost* to the first coat of *Lifeline Interior*.

- Long-lasting interior color coat
- Transparent color choices
- One or more color coats maximize your interior color choices
- Easy application and maintenance
- High coverage rates
- Fast drying
- Very low VOC formula
- Compatible with all *Perma-Chink Systems* wood care products



Lifeline Interior will not yellow. You can apply multiple coats to develop the color and film thickness that you desire. *Lifeline Interior* is completely compatible with our other interior finish options.

Wood Stain and Finishes

Interior

Lifeline Interior™

Interior Stain for Walls, Ceilings and Other Surfaces



Surface Preparation:

Must be applied to clean, dry surface.

Application Rates:

1st coat - 350-450 sq. ft. per gallon depending on the porosity of the wood.

2nd coat - 600-800 sq. ft. per gallon.

Application Temperature:

40° F to 90° F

Application Methods:

Airless sprayer with back-brushing to ensure even coverage OR all by brush. Stir before and frequently during application.

of Coats:

One or more coats depending on the desired color. Stir container every 15 minutes. Backbrush and maintain a wet edge. Topcoat with Lifeline Acrylic Clear Topcoat or Sure Shine.

Drying Time:

Dry to the touch in 1 to 4 hours. Cures in 72 hours.

Clean up:

Soap and water.

Packaging:

1-gallon container.
5-gallon pail.
Samples available.

Storage/Shelf Life:

Freeze/thaw stable.
3 years.



Clear #110



Butternut #154



Hazelnut #170



Cinnamon #174



Light Honey #112



Dark Honey #122



Driftwood #161



Walnut #165



Light Natural #120



Dark Natural #130



Stone Gray #163



Gentry Gray #142

★ New Colors



Pickled White #150



Seagull #152

Custom Colors Available

Application techniques, wood species and other factors will affect the actual color when finished. We supply samples for evaluation on your specific wood.



Wood Stain and Finishes

Interior



ROCKY MOUNTAIN HOMES

Color in this photo closely represents Lifeline Interior Hazelnut. Actual results will vary. Contact Perma-Chink Systems for samples.

Wood Stain and Finishes

Interior

Lifeline Acrylic™

Gloss/Satin

Clear Topcoat for Interior Millwork and Walls

Lifeline Acrylic is a furniture grade clear coat for interior use. *Lifeline Acrylic* forms an attractive and durable protective film that adds depth to the finish and makes cleaning wood surfaces a breeze. It can be applied over *Lifeline Interior*, *Lifeline Accents*, *Prelude* or directly onto bare wood.

- Excellent for interior walls, cabinets, paneling, timbers and wood trim
- Highlights the beauty of stained or bare wood
- Protects stain and sealers from abrasion and wear
- Resists yellowing



Satin

Gloss



StoneMill Log Homes



Hearthstone Log Homes

- Easy application
- High coverage rates
- Fast drying
- Very low VOC formula
- Compatible with all *Perma-Chink Systems* wood care products
- Environmentally friendly
- Free samples

PURDY®,
WOOSTER®,
STAINER®
Brushes



Surface Preparation:

Must be applied to clean, dry surface.

Application Rates:

350-450 sq.ft. per gallon on bare wood (1st coat) depending on the porosity of the wood.

600-800 sq.ft. per gallon on finished wood (2nd coat).

700-900 sq.ft. per gallon on subsequent coats (3rd coat).

Application Temperature:

40° F to 90° F

Application Methods:

Airless sprayer with back-brushing to ensure even coverage OR all by brush. Stir before and frequently during application.

of Coats:

One to multiple coats depending on desired film thickness.

Drying Time:

Dry to the touch in 2 to 4 hours. Cures in 72 hours.

Clean up:

Soap and water.

Packaging:

1-gallon container.
5-gallon pail.
Samples available.

Storage/Shelf Life:

Freeze/thaw stable.
3 years.



Wood Stain and Finishes

Interior



HEARTHSTONE HOMES

Color in this photo closely represents Lifeline Interior Dark Honey. Actual results will vary. Contact Perma-Chink Systems for samples.

Wood Stain and Finishes

Interior

Sure Shine™

Gloss/Satin

Premium Waterborne Polyurethane-Acrylic Finish

Sure Shine is our most durable indoor clear finish. It is suitable for all your wood floors and any other interior surface where you want a lustrous or deep-shine finish. If you want a clear diamond finish using fewer coats, *Sure Shine* premium finish is the one to use!

- High coverage rates
- Fast drying, easy to apply
- Resists scuffing and abrasion
- Very low VOC formula
- Compatible with all *Perma-Chink Systems* wood care products
- Environmentally friendly
- Free samples



Rocky Mountain Log Homes



Sierra Log & Timber



Strongwood Log Homes



Satterwhite Log Homes

Surface Preparation:

Must be applied to clean, dry surface.

Application Rates:

350-450 sq.ft. per gallon on bare wood (1st coat) depending on the porosity of the wood.

600-800 sq.ft. per gallon on finished wood (2nd coat).

700-900 sq.ft. per gallon on subsequent coats (3rd coat).

Application Temperature:

40° F to 90° F

Application Methods:

Airless sprayer with back-brushing to ensure even coverage OR all by brush. Stir before and frequently during application.

of Coats:

One to multiple coats depending on desired film thickness. Sand between each coat once cured.

Clean up:

Soap and water.

Drying Time:

Dry to the touch in 2 to 4 hours. Cures in 72 hours.

Packaging:

1-gallon container.
5-gallon pail.
Samples available.

Storage/Shelf Life:

Freeze/thaw stable.
3 years.



Chinking and Specialty Sealants

Interior & Exterior

Sealants Overview



Permanently Seal and Protect Your Log or Timber Home

“Chinking” is a term descended from Old English to describe the sealing of gaps and joinery around the interior and exterior of your home. These gaps can allow air and water infiltration and must be properly sealed. A major benefit of a well-sealed home is much better energy efficiency and comfort.

Accept No Substitutes

In 1981 we invented synthetic Chinking as a permanent solution for sealing and protecting your home. Today, as thousands of satisfied customers can attest, there simply is no substitute for Sealant Systems manufactured by *Perma-Chink Systems*.

Versatile Sealant Systems

We have developed ideal solutions for sealing gaps in and around your custom home. *Perma-Chink* will seal wide gaps and is textured to simulate mortar. *Energy Seal* is ideal for sealing narrow gaps and is formulated to blend in with the surrounding finish system.

Highest-Quality Ingredients

All of our sealants are specially formulated with premium acrylic latex. We never skimp on quality, which is why our sealants consistently outperform all competitive products.

Protecting your Dream Home

Air and water infiltration are a threat to your greatest asset – your natural wood home. You will appreciate the peace of mind that can only come from using our Sealant Systems.

Virtually Maintenance-Free

We have single-handedly reduced the cost and effort of maintaining your natural wood home. You can look forward to decades of performance from all of our quality sealants.



Backed by a 10-year Warranty

We are so confident in our *Perma-Chink* sealant that we back it with a full 10-year warranty. Properly installed *Perma-Chink* will not tear and or delaminate from the surrounding wood for decades to come.

Our Sealant Systems used with our Exterior Finish Systems, offer the lowest maintenance solution to beautify and protect your log or timber home. Contact a *Perma-Chink Systems* product support specialist today for color samples and application guidelines.

Chinking and Specialty Sealants

Interior & Exterior

Energy Seal™

Specialty Sealant for Log Homes

Energy Seal is specially formulated for sealing narrow gaps in log home joinery such as butt joints, window trim, door trim and corners.

It is lightly textured to match wood surfaces for applications where you would like the sealant to be invisible. *Energy Seal* accepts stain colors and blends into the surface of wood joinery.

- Highly elastic
- For use in gaps up to 1 inch wide
- Maintenance free
- Very low VOC formula
- Soap and water cleanup
- Compatible with all *Perma-Chink Systems* wood care products



White #507



Natural Pine #520



Sierra Brown #505



Slate Gray #542



Desert Tan #519



Golden Honey #545



Cedar #530



Dark Natural #550



Classic Brown #523



Adobe #555



Walnut #565



Earthtone #560

Surface Preparation:

Must be clean and dry and free of oils and wax. Use Backer Rod wherever possible.

Application Rates:

See coverage rate table.

Application Temperature:

40° F to 90° F

Application Methods:

Chink Pump.
Bulk loading gun.
Caulk gun.
Application bag.

of Coats:

Apply at 3/8" thickness. Do not apply in direct, hot sunlight.

Drying Time:

Skins over in 20 minutes.
Complete curing may take 3 to 8 weeks depending on temperatures and humidity.

Clean up:

Soap and water.

Packaging:

11 oz. tubes.
30 oz. tubes.
5 gallon pail.

Storage/Shelf Life:

Freeze/thaw stable.
3 years.

Energy Seal Coverage Rates

To be applied 5/16" - 3/8" thickness			
Width of gap	Feet per 11-oz. tube	Feet per 30-oz. tube	Feet per Pail
1/2"	16'	48'	975'
3/4"	11'	32'	650'
1"	8'	24'	490'

Color representations are as close as possible to actual colors. Application techniques and other factors will affect the actual color when finished. We supply samples for evaluation on your specific wood.



Chinking and Specialty Sealants

Interior & Exterior

Perma-Chink®

Introducing the ONE-and-ONLY Chinking You Need to Know!

Advanced Formula

Molecular breakthrough technology created a Blister Proof, NO-Slump chinking that provides superior adhesion and elongation. It is also heat and age resistant, yet highly workable for ease of application.

Perma-Chink was the first synthetic chinking produced in 1981. There have been many significant changes made in formulations to improve adhesion, flexibility, and longevity.

For the past two years Perma-Chink Systems intensively researched and tested adhesion, elongation, workability, heat resistance and process stability of *Perma-Chink* chinking. These extensive studies concluded successfully when our chemists were able to incorporate molecular breakthrough technology to create a Blister Proof, NO-slump chinking.

Today's *Perma-Chink* offers excellent qualities in all areas to meet the needs of the industry.

- Highly Elastic - Stretches to Accommodate Log Movement.
- Great Viscosity - Tools Easy in Low and High Temperatures.
- Will not Slump - Applied Film Stability.
- Blister Proof - Excellent Heat Resistance.
- Great Adhesion - Resists Separation from Logs.
- Low VOC - Environmentally Friendly.
- Freeze/Thaw Stable.
- Beautiful Color Palette to Match Shades and Hues of Today's Finishes.

Blister Test Result for *Perma-Chink*



Blister Test Result for Other Brand



The RHEOLOGY of *Perma-Chink*

Theoretical aspects of rheology are the relation of the flow/deformation behavior of material and its internal structure. The rheology additives in *Perma-Chink* help ensure that the polymer properties meet specifications for the end use (texture, product film properties) and product quality.

Rheological properties of *Perma-Chink*:

Greatly improved low shear (as in standing after application) results in high viscosity to prevent slumping. High shear (as in pumping) decreases viscosity to make the product easier to apply and tool.

Slump Test Result for *Perma-Chink*



Slump Test Result for Other Brand



* Substrate conditions such as substrate outgassing, volatiles in the wood and backing materials can contribute to formation of blisters.

Chinking and Specialty Sealants

Interior & Exterior

Perma-Chink®

The Original Flexible Chinking for Log Homes

Perma-Chink log home sealant started the company and remains the product for which we are known, even though we have developed a complete system of products for log home care and maintenance. *Perma-Chink* looks like traditional mortar. It stretches, compresses and tightly adheres to wood surfaces to make your log walls weather tight and attractive. It is still the easiest chinking to apply to your log home.



- Highly elastic
- Use for interior and exterior sealing
- Seals gaps 1 inch or wider
- Maintenance free
- Very low VOC formula
- 10-year warranty
- Compatible with all *Perma-Chink Systems* wood care products

Perma-Chink Coverage Rates

Gap Width	Linear Feet per Pail
1/2"	Use Energy Seal
3/4"	Use Energy Seal
1"	385'
1-1/2"	256'
2"	192'
2-1/2"	154'
3"	127'
3-1/2"	110'
4"	96'
4-1/2"	85'
5"	76'
6"	63.5'

1 Pail = approximately fifty-five 11 oz. tubes

1 Pail = approximately twenty 30 oz. tubes



White #207



Stone #211



Light Gray #212



Medium Gray #224



Sandstone #215



Beige #216



Tan #219



Brown #223

Surface Preparation:

Must be clean and dry and free of oils and wax. Proper backing materials and/or bond breaker must be used.

Application Rates:

See coverage rate table.

Application Temperature:

40 ° F to 90 ° F

Application Methods:

Chink Pump.
Bulk loading gun.
Caulk gun.
Application bag.

of Coats:

Apply at 3/8" thickness. Do not apply in direct, hot sunlight.

Drying Time:

Skins over in 20 minutes. Complete curing may take 3 to 8 weeks depending on temperature and humidity.

Clean up:

Soap and water.

Packaging:

11 oz. tubes.
30 oz. tubes.
5-gallon pail.

Storage/Shelf Life:

Freeze/thaw stable.
3 years.

Color representations are as close as possible to actual colors. Application techniques and other factors will affect the actual color when finished. We supply samples for evaluation.



Chinking and Specialty Sealants

Interior & Exterior



STONEMILL LOG & TIMBER HOMES

Color in this photo closely represents Lifeline Ultra-2 Gentry Gray. Actual results will vary. Contact Perma-Chink Systems for samples.

Chinking and Specialty Sealants

Interior & Exterior

Chink-Paint™

Change or Renew the Color of Your Chinking

Chink-Paint is a high-quality latex paint that is textured to look like *Perma-Chink* log home sealant. *Chink-Paint* can be used to renew or completely change the color of existing chinking. On cosmetic chink joints less than ¼ inches deep *Chink-Paint* can be used to give the home a traditional chinking look. *Chink-Paint* is available in the same eight colors as *Perma-Chink* log home sealant. Available in eight *Perma-Chink* colors, see page 25.



Linear Feet per Gallon

- 2" joint - 600 feet
- 3" joint - 400 feet
- 4" joint - 300 feet

Surface Preparation:

Surface of wood or existing chinking must be clean and dry.

Application Rates:

100 sq.ft. per gallon.

Application Temperature:

40° F to 90° F

Application Methods:

Short bristled brush.

of Coats:

1 coat.

Drying Time:

1 hour.

Clean up:

Soap and water.

Packaging:

1-gallon pail.
5-gallon pail.

Storage/Shelf Life:

DO NOT FREEZE!
3 years.

Chink-Paint™ Smooth

Change or Renew the Color of Your Chinking

Chink-Paint Smooth is a highly elastomeric, non-textured, pure acrylic latex paint for renewing or changing the color of chinking. The elasticity of *Chink-Paint Smooth* enables it to expand and contract with the sealant without cracking or peeling. This material makes it easy to complete the “facelift” process for your log home. *Chink-Paint Smooth* is ideal to use on your chink lines following a wood finish restoration. Simply wait for the stain to dry and apply a coat of *Chink-Paint Smooth*. Available in eight *Perma-Chink* colors, see page 25.



Surface Preparation:

Surface of wood or existing chinking must be clean and dry.

Application Rates:

100 sq.ft. per gallon.

Application Temperature:

40° F to 90° F

Application Methods:

Short bristled brush.

of Coats:

1 coat.

Drying Time:

1-2 hours.

Clean up:

Soap and water.

Packaging:

1-gallon pail.
5-gallon pail.

Storage/Shelf Life:

DO NOT FREEZE!
3 years.

Linear Feet per Gallon

- 2" joint - 600 feet
- 3" joint - 400 feet
- 4" joint - 300 feet



Chinking and Specialty Sealants

Interior & Exterior



STRONGWOOD LOG HOME COMPANY

Color in this photo closely represents Lifeline Interior Light Natural. Actual results will vary. Contact Perma-Chink Systems for samples.

Chinking and Specialty Sealants

Interior & Exterior

Check Mate 2®

Seals Cracks and Checks in Logs

Protect your logs from water infiltration by sealing upward facing checks and cracks that can develop along log surfaces.

Check Mate 2 is specially formulated to complement the colors of our *Lifeline* finishes.



Clear



Yellow Brown



Golden Brown



Dark Brown



Copper Brown



Medium Brown



Walnut Brown

Color representations are as close as possible to actual colors. Application techniques and other factors will affect the actual color when finished. We supply samples for evaluation on your specific wood.

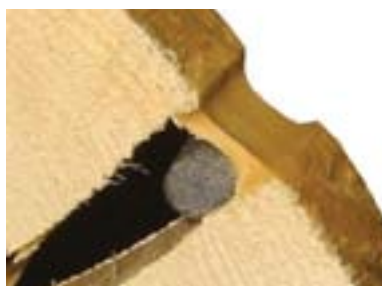

Clean up:

Soap and water.

Packaging:

11 oz. tubes.

Storage/Shelf Life:

Freeze/thaw stable.
1 year.

Surface Preparation:

Surface of checks must be clean and dry and free from any oils or wax. Use Backer Rod wherever possible.

Application Rates:

One 11 oz. tube will seal 16 feet of 1/2 inch wide or 32 feet of 1/4 inch wide checks.

Application Temperature:

40° F to 90° F

Application Methods:

Caulk gun.

of Coats:

Apply at 3/8" thickness. Do not apply in direct, hot sunlight.

Drying Time:

Skins over in 1 hour. Complete curing may take several days depending on temperatures and humidity.



Application Tools

The *Albion* bulk loading caulking gun is our most popular tool for applying *Perma-Chink* or *Energy Seal*.



NEW AND IMPROVED

The *Follow Plate* makes bulk loading much easier and cleaner.

We stock a wide selection of quality trowels and spatulas used for tooling *Perma-Chink*, *Energy Seal*, *Check Mate 2* and *Woodsman*.

Available Sizes:

Straight Spatulas

Blade Width and Length:

2" x 14"
1-1/2" x 10"
1-1/4" x 8"
1-1/4" x 6"
3/4" x 4"

Bent Spatulas

Blade Width and Length:

1-1/2" x 10"
1-1/4" x 8"
3/4" x 5" (tapered)
3/4" x 4 1/2"

Bent Trowels

Blade Width:

4"
3"
2"
1-1/2"
1-1/4"



Chinking and Specialty Sealants

Interior & Exterior

Woodman™

A Smooth Surfaced Log and Timber Home Sealant

Woodman is a high performance, elastic sealant for general use around your house. It can be used during construction between logs, in butt-joints, around windows and doors, woodwork, eaves, soffits, vents, and expansion joints. It cures to form a highly stretchable seal that is UV resistant, water-tight and airtight. It is durable and available in a variety of colors.

Woodman tightly adheres to all materials, including wood, metal, concrete, brick, masonry, porcelain, tile, marble, glass and plastics; and stretches to maintain a tight seal.

Surface Preparation:

Must be clean and dry and free of oils and wax. Use Backer Rod wherever possible.

Application Rates:

See coverage rate table.

Application Temperature:

40° F to 90° F

Application Methods:

Caulk gun.

of Coats:

Apply at 3/8" thickness. Do not apply in direct, hot sunlight.

Drying Time:

Skins over in 20 minutes. Complete curing may take 3 to 8 weeks depending on temperatures and humidity.

Clean up:

Soap and water.

Packaging:

11 oz. tubes.
30 oz. tubes.

Storage/Shelf Life:

Freeze/thaw stable.
3 years.



Pine #615



Honey #625



Tan #635



Cedartone #645



Brown #655



Gray #665

Woodman Coverage Rates

Diameter of Bead	feet per	feet per
	11-oz. tube	30-oz. tube
1/4"	32'	92'
3/8"	14'	41'
1/2"	8"	23'

Log Home Gasket Tape

- Closed-cell, medium density PVC foam.
- Pressure sensitive adhesive.
- Maintains a uniform seal between logs.
- Pliable between -5° F and 170° F.

3/8 inch, roll of 25 feet (40 rolls/case)

1/2 inch, roll of 25 feet (30 rolls/case)

1 inch, roll of 25 feet (15 rolls/case)



Chinking and Specialty Sealants

Interior & Exterior

Grip Strip™

Backing Materials and Bond Breakers

Grip Strip is a chemically inert closed-cell polyethylene that is shaped to fit between log courses to form a flat surface for the application of *Perma-Chink* or *Energy Seal*. This makes it easier to maintain a consistent thickness of sealant across the seam, reducing the amount of sealant required and improving the sealant's performance.

Advantages of Using *Grip Strip*

- It provides a firm chinking or caulking surface
- Its shape and texture allow it to be easily installed without using staples, nails or glue
- It repels water. (Most open cell products absorb water)
- It is compatible with all commonly available synthetic chinking
- It helps prevent blistering of chinking surfaces
- It provides extra insulation against heat loss



Width Sizes

3/4 inch	1200'	per Case
1 inch	960'	per Case
1-1/4 inches	600'	per Case
1-1/2 inches	460'	per Case
2 inches	360'	per Case
3 inches	200'	per Case
4 inches	144'	per Case
5 inches	120'	per Case
6 inches	96'	per Case

Backer Rod™

Backing Materials and Bond Breakers

Backer Rod is an extruded closed-cell polyethylene rod that is used in cracks, checks, and gaps before filling them with sealants such as *Perma-Chink*, *Energy Seal* and *Check Mate 2*. Caulk joints should not be more than 3/8" thick and *Backer Rod* provides a way to fill a deep crevice or gap while maintaining the proper sealant thickness for maximum performance.

Backer Rod should also be used in checks over 1/4" wide before applying *Check Mate 2*.



- Closed cell polyethylene.
- Will not absorb water.
- Heat and cold stable.
- Should be used to ensure proper thickness of sealants including *Perma-Chink*, *Energy Seal* and *Check Mate 2*.

Width Sizes

1/4 inch	6400'	per Case
3/8 inch	3600'	per Case
1/2 inch	2500'	per Case
3/4 inch	1100'	per Case
1 inch	550'	per Case

Handy-Pak Sizes

1/4 inch	3200'	per Case
3/8 inch	1800'	per Case
1/2 inch	1250'	per Case

Log Gap Cap™

Reduces air infiltration where round logs meet window and door jamb trim.

- Pre-cut foam inserts fit most round log profiles.
- Can be cut easily to fit in different sized log diameters.
- Seal over with *Energy Seal* to virtually stop any water or air infiltration.



Chinking and Specialty Sealants

Exterior



ROCKY MOUNTAIN HOMES

Color in this photo closely represents Lifeline Ultra-2 Oak. Actual results will vary. Contact Perma-Chink Systems for samples.

Sealing Around Windows & Doors



No More Air Loss or Water Leaks Around Your Windows and Doors

1. Use masking tape around the window or door seam.
2. Insert *Log Gap Cap* into the crevice using trowel.
**Log Gap Cap* provides an even surface for sealant application and makes it easier to apply a uniform thickness across the gap.
3. Apply *Energy Seal* or *Perma-Chink*.
4. Tool smooth.
5. Remove masking tape as soon as tooling is complete.

Application Guns

Ratchet Style Caulking Guns to apply log chinking and log home sealants, fits 11 oz and 30 oz tubes.

For applying *Perma-Chink*, *Energy Seal*, *Check Mate 2* and *Woodsman*.



The *Albion* bulk loading caulking gun for applying *Perma-Chink* or *Energy Seal*.

- Professional Quality
- Efficient 12:1 Drive Ratio
- Lightweight Aluminum Barrel
- Double Grip Plates for Long Life

No spanner wrench needed! Barrel is made to rotate.

Cordless *Albion* lightweight bulk loading gun for *Perma-Chink* and *Energy Seal*.



Available in 20 oz

- Powerful - 400 lbs of Dispensing Force
- Fast - Dispense cartridge in seconds
- Long-Lasting - 12 V Lithium Ion Battery
- Control - Variable Speed Trigger

Borate Wood Preservatives

Interior & Exterior

Armor-Guard®

Soluble Borate Powder

Armor-Guard is a borate powder that is dissolved in water for use. Add *Armor-Guard* to water in a pail or bucket, stir until the solution is clear and apply with a low-pressure sprayer. *Armor-Guard* protects uninfested wood from wood decay and wood destroying insects.

Like all borate treatments, exterior surfaces should be protected with one of our *Lifeline* exterior finish systems. *Armor-Guard* stays near the surface and we recommend that it be reapplied if the finish system is physically or chemically removed.



Surface Preparation:
Must be applied to clean and dry bare wood.

Application Rates:
Approx. 200 sq.ft. per gallon of mixed solution. A 17 lb. pail covers approx. 3400 sq.ft.

Application Temperature:
40° F to 90° F

Application Methods:
Low pressure sprayer.
Drill and inject.

of Coats:
1 coat application. Mix 1 pound (4 cups or 2 of the enclosed scoops) of powder with one gallon water for use.

Drying Time:
1 to 3 days.

Clean up:
Soap and water.

Packaging:
1 lb. bag.
17 lb. pail.

Storage/Shelf Life:
Keep dry.
5 years.

Shell-Guard®

Borate Wood Preservative Concentrate

Shell-Guard Concentrate is a combination of glycols and borate that must be mixed with an equal volume of water for use. The diluted solution is applied to bare wood and impregnates the wood fibers with the active borate ingredient eliminating and providing protection against wood decay fungi and wood consuming insects.

Like all borate-based wood preservatives the diluted *Shell-Guard* solution must be applied to unfinished bare wood. One application of diluted *Shell-Guard Concentrate* is permanent when exterior wood surfaces remain protected with one of our *Lifeline* exterior finish systems.



Surface Preparation:
Must be applied to clean and dry bare wood.

Application Rates:
One gallon of *diluted solution* to 108 sq.ft. of wood surface.

Application Temperature:
40° F to 90° F

Application Methods:
Low-pressure sprayer.
Drill and inject.

of Coats:
1 coat application.
Mix 1:1 with warm water for use.

Drying Time:
2 to 3 weeks. Wash surface with *Log Wash* before applying finish.

Clean up:
Soap and water.

Packaging:
1-gallon container.
2.5-gallon container.
5-gallon carton.

Storage/Shelf Life:
Freeze/thaw stable.
5 years.

Cobra™ Rods

Cobra Rods are used to spot treat decay-prone areas such as log ends that are coated with a finish. Once inserted into damp or wet wood the borate/copper complex in *Cobra Rods* dissolves spreading the active ingredients into areas surrounding the rod. This eliminates active decay fungi and helps prevent rot for 8 to 10 years.

Cobra Rods are 7/16" in diameter and 2" long. The installation holes may be plugged with the accompanying plastic plugs and hidden with *Energy Seal*. A typical 6 to 8 inch round log end will require two 2" long *Cobra Rods* inserted within 4 inches of the butt end.



Cobra™ Rods are a trademark of Genics Inc., Canada

Borate Wood Preservatives

Interior & Exterior

Shell-Guard® RTU

Ready-To-Use Wood Preservative

Borates are recognized as being the most effective “green” wood preservatives that are available. *Shell-Guard RTU* is a ready-to-use borate/glycol wood preservative that is colorless, odorless and has a very low toxicity to people and pets. It is effective for preventing and eliminating wood decay and wood destroying insect infestations in exterior and interior wood members.

Shell-Guard RTU must be applied to bare wood for it to work. Although most borate products must be dissolved in water prior to use, *Shell-Guard RTU* is ready-to-use so you can pour it right out of the container into your low-pressure sprayer without the fuss of measuring, mixing and stirring. And if you have any left over you can pour right back into the container for later use.

Another advantage to *Shell-Guard RTU* is its quick drying time. Your logs will be ready to finish one to three days after it's applied. Since it penetrates into the wood, one application of *Shell-Guard RTU* is permanent when exterior wood surfaces remain protected with one of our *Lifeline* exterior finish systems. *Shell-Guard RTU* is labeled for the control of termites, wood boring beetles, carpenter ants and wood decay fungi.

Surface Preparation:
Must be applied to clean and dry bare wood.

Application Rates:
1 gallon will cover 150 to 250 sq.ft. of wood surface.

Application Temperature:
40° F to 90° F

Application Methods:
Low-pressure sprayer.
Drill and inject.

of Coats:
1 coat application.

Drying Time:
1 to 3 days.

Clean up:
Soap and water.

Packaging:
1 gallon container.
2.5 gallon container.
5 gallon carton.

Storage/Shelf Life:
Store in heated area.
3 years.



STOP THOSE PESKY CRITTERS FROM EATING AWAY YOUR INVESTMENT!



	Shell-Guard RTU	Shell-Guard Concentrate	Armor-Guard
Mixing	No mixing required.	Mix 1 to 1 with water.	Mix 1 lb. per gallon of water.
Washing	Not required.	Wash down after 2 weeks.	Not required.
Duration of Treatment	Permanent treatment.	Permanent treatment.	Should be reapplied if home is stripped.
Limitations	Not for sale in California or Canada	Not for sale in Canada.	Should be used only on new uninfested wood. Not for sale in Canada

Wood Cleaners and Strippers

Interior & Exterior



SATTERWHITE LOG HOMES

Color in this photo closely represents Lifeline Ultra-7 Cedar. Actual results will vary. Contact Perma-Chink Systems for samples.

Wood Cleaners and Strippers

Interior & Exterior

Log Wash™

**A Liquid Concentrate for Cleaning and Conditioning Bare Wood Surfaces,
Exterior and Interior Lifeline Finishes**

Cleaning Bare Wood

Log Wash is the best product to use for cleaning all bare wood surfaces. Its low pH formula is compatible with the chemistry of wood which prevents unwanted reactions that can darken or discolor bare wood surfaces.

Besides removing dirt, dust, mold, pollen and sanding and blasting media residue, *Log Wash* will remove many types of bare wood discolorations including brown chemical stains. We strongly recommend that all bare wood surfaces be washed and conditioned with a *Log Wash* solution before applying any of our finish systems.



Before



After

Surface Preparation:

Use *Log Wash* instead of bleach for cleaning wood surfaces.

Application Rates:

150 to 250 sq. ft. per gallon of diluted *Log Wash*.

Maintenance Cleaning:

Exterior coated surface (1 cup/gallon of water); Interior coated surface (1/2 cup/gallon of water).

Cleaning Bare Wood:

Exterior wood surface (2 cups/gallon of water), Interior wood surface (1 cup/gallon of water)

Application Temperature:

40° F to 90° F

Application Methods:

Low-pressure sprayer.

of Coats:

Use 1 cup per gallon for maintenance cleaning. Use 2 cups per gallon for cleaning bare wood.

Drying Time:

Never allow to dry on wall.

Clean up:

Water.

Packaging:

1-gallon container.

Storage/Shelf Life:

Freeze/thaw stable.
3 years.



Maintenance Cleaning

Use *Log Wash* for washing the dust and dirt off interior and exterior finished wood surfaces. Its unique formulation removes dust, dirt and other contaminants from walls and chinking without harming them. Washing your home once or twice a year with *Log Wash* will keep your *Lifeline* finish looking great and will help extend its life.

Cedar Wash™

A ready-to-use cleaner for Western Red Cedar, Redwood, Walnut and Mahogany

Cedar Wash is designed to remove surface resin oils, high concentrations of water-soluble wood extractives, dirt, grease, grime, pollen, and surface mold and mildew without harming the wood.

- Removes resin oils and wood extractives
- Removes dirt, dust, and pollen
- Will not harm finishes, chinking and sealants that are in good condition
- Very low environmental impact



Surface Preparation:

Use to remove resin, oils and wood extractives from the surface.

Application Rates:

175 to 225 sq. ft. per gallon of ready-to-use *Cedar Wash* solution.

Application Temperature:

40° F to 90° F

Application Methods:

Low-pressure sprayer.

of Coats:

Only one liberal coat to bare wood.

Drying Time:

Never allow to dry on wall.

Clean up:

Water.

Packaging:

2.5-gallon or 5-gallon container.

Storage/Shelf Life:

Freeze/thaw stable.
3 years.

Wood Cleaners and Strippers

Interior & Exterior

Wood ReNew™

Renews the Natural Beauty of Bare Wood

Wood ReNew is a cleaning concentrate for use on bare wood surfaces. A safe, effective cleaner, it is the best product to use for removing UV damaged gray wood fibers.

Wood ReNew will also help remove old worn finishes, mill glaze, mold, mildew, and dirt from wood surfaces. *Wood ReNew* is not a maintenance cleaner for cleaning finished surfaces.

One gallon of *Wood ReNew* makes 20 gallons of solution, enough to clean approximately 3000 sq. ft. of wood surface.

Surface Preparation:

Use *Wood ReNew* to help remove grayed wood fibers, mill glaze, mold and mildew.

Application Rates:

Add 4 cups of *Wood ReNew* to 5 gallons of water. Each gallon of mixed solution will clean approx. 150 sq.ft. of wood surface.

1 gallon container of *Wood ReNew* will clean approx. 3000 sq.ft.

Application Temperature:

40° F to 90° F

Application Methods:

Sponge.
Scrub brush.
Mop.

of Coats:

As needed. Works best if used along with a pressure washer. Thoroughly rinse.

Drying Time:

Never allow to dry on wall.

Clean up:

Water.

Packaging:

1-gallon container.
Samples available.

Storage/Shelf Life:

Freeze/thaw stable.
5 years.



Oxcon™

Concentrate Oxalic Acid Solution

Oxcon is the only product that will remove dark colored streaks from metallic tannates. It must be diluted with four parts water for use. *Oxcon* solution will remove rust stains caused by nails, screws, and fasteners.

Use *Oxcon* only when needed. We recommend the use of pH Strips to verify that the surface has been adequately rinsed after using any cleaning product.

Surface Preparation:

Clean surface with Log Wash before using *Oxcon*.
Note: *Oxcon* is not formulated to remove intact paint, stain, or clear finishes and may dull painted or metal surfaces if not quickly rinsed with water.

Application Rates:

200 sq.ft. per gallon of mixed solution.
One gallon of *Oxcon* makes 5 gallons of mixed solution and cleans approximately 1000 sq.ft.

Application Temperature:

40° F to 90° F

Application Methods:

Low-pressure sprayer.

of Coats:

One application. Thoroughly rinse. Use pH strips to assure adequate rinsing.
Do not use as a spot treatment.

Drying Time:

Never allow to dry on wall.

Clean up:

Water.

Packaging:

1-gallon container.
5-gallon pail.
Samples available.

Storage/Shelf Life:

DO NOT FREEZE!
1 year.



pH Strips

A Note About Rinsing

No matter what product you use to clean bare wood, nothing is more important than making sure you have adequately rinsed the surface. Any chemical residue remaining on the wood can have serious consequences later on.

We always recommend using pH Strips to make sure that the surface of the wood has been sufficiently rinsed, preferably to a pH of between 6.5 and 7.5.

Take the guesswork out of rinsing cleaners and strippers by using pH strips.



Wood Cleaners and Strippers

Interior & Exterior

S-100™

An Environmentally Friendly Finish Remover

S-100 Finish Remover is an easy to use water-based solvent that removes most types of oil and water-based finishes. *S-100* is a gel that can be applied with a brush or an airless sprayer. Once the existing finish has softened a pressure washer is required to remove the finish. The high water solubility of *S-100* makes it easy to clean up. Since it is biodegradable there is no concern about contaminating the surrounding soil.

Unlike sodium or potassium hydroxide strippers, *S-100* will not darken or discolor the wood. *S-100* may not be effective for removing some high-performance coatings that may require a more aggressive chemical finish remover such as *StripIt*. We strongly recommend that you obtain and test free samples of both *S-100* and *StripIt* before placing an order.



Surface Preparation:
None.

Application Rates:
50 to 100 sq.ft. per gallon.

Application Temperature:
50° F to 90° F

Application Methods:
Brush.
Roller.
Airless sprayer.

of Coats:
As needed.

Drying Time:
Do not allow to dry on wall.

Clean up:
Water.

Packaging:
5-gallon pail.
Samples available.

Storage/Shelf Life:
Freeze/thaw stable.
3 years.



StripIt®

High-Performance Stain and Finish Remover



StripIt is a water-based, non-hazardous pH neutral stain and finish remover. *StripIt* is an odor free product that will not darken the wood and can remove multiple layers in one application. It can be used for interior and exterior applications. It will not raise the grain.

StripIt quickly and easily cleans up with water. As with any chemical, it is imperative to follow the directions on the label. We recommend the use of *pH Strips* to ensure the surface has been adequately rinsed after using any chemical strippers.

- Will not harm or discolor chinking or sealants
- Will not harm, mar or discolor metal surfaces
- Odor free
- Zero VOC



Surface Preparation:
None.

Application Rates:
40-55 sq.ft. per gallon.

Application Temperature:
40° F to 90° F

Application Methods:
Airless sprayer.
Brush.
Roller.

of Coats:
As needed.

Drying Time:
Do not allow to dry on wall.

Clean up:
Water.

Packaging:
5-gallon pails.
Samples available.

Storage/Shelf Life:
Protect from freezing.
2 years.

Wood Restoration Epoxies

Interior & Exterior

M-Balm™

Epoxy Wood Consolidator

Wood that has lost its integrity due to decay or insects can be hardened and consolidated with *M-Balm*. This two-component liquid epoxy penetrates into soft, porous or spongy wood to form a strong water-resistant mass. *M-Balm* should always be used in preparation for filling pockets of decayed wood with *E-Wood* epoxy putty.

- Two-component liquid epoxy
- Low viscosity for penetration into soft, spongy and porous wood
- Forms a hard, water-resistant mass
- Should be used prior to filling pockets of decayed wood with *E-Wood*



Applying *M-Balm*



Wood fibers consolidated with *M-Balm*

Surface Preparation:
Apply only to dry wood.

Application Rates:
15 to 20 sq.in. per ounce of mixed *M-Balm*.

Application Temperature:
40° F to 90° F

Application Methods:
Squeeze bottle.
Syringe.
Small brush.

of Coats:
Thoroughly saturate wood.

Drying Time:
Do not allow to dry on wall.

Clean up:
Uncured mixed *M-Balm* (Part A and Part B) may be cleaned up with white vinegar then flushed with water.

Packaging:
2-component 24 oz. package.
2-component 1.5 gallon package.

Storage/Shelf Life:
Freeze/thaw stable.
1 year.



Contractor References

We can refer you to friendly professional contractors in your area who use and recommend our products.

E-Wood™

Epoxy Wood Putty

For filling voids in decayed wood, *E-Wood* is the perfect product to use. *E-Wood* is a two component epoxy wood putty that may be used to fill in wood voids. It can be textured to match the appearance of the surrounding wood. Hardened *E-Wood* filler can be sanded, shaped and stained.

- Two-component wood tone epoxy putty
- Can be shaped, molded and textured to match the surrounding wood
- Soft or decayed wood should be consolidated with *M-Balm* first
- Hardens in 2 to 4 hours



Cavity filled with *E-Wood*



Stain applied to *E-Wood*

Surface Preparation:
Should be applied after using *M-Balm*. No waiting is necessary.

Application Rates:
1.8 cubic inches per ounce mixed A & B components.

Application Temperature:
40° F to 90° F

Application Methods:
Press into voids using gloved hands.

of Coats:
Tool and texture within 30 minutes of application.

Drying Time:
Hardens in 2 to 4 hours depending on temperature.

Clean up:
Uncured mixed *E-Wood* (Part A and Part B) may be cleaned up with white vinegar then flushed with water.

Packaging:
2-component 32 oz. package.
2-component 2-gallon package.

Storage/Shelf Life:
Freeze/thaw stable.
1 year.



Wood Restoration Epoxies

Interior & Exterior

E-Wood™ Paste

Epoxy Wood Paste

E-Wood paste works excellent on window trims, small checks on log ends and other places where putty may be difficult to apply. It can be textured to match the appearance of the surrounding wood. Combine equal parts of *E-Wood Paste* by volume (A & B) and mix together by kneading or with a spatula until the color is uniform while wearing disposable gloves. Mix no more than what can be applied in 15 minutes. Allow product to cure before sanding and staining.

- Two-component wood tone epoxy putty
- Can be shaped, molded and textured to match the surrounding wood
- Soft or decayed wood should be consolidated with *M-Balm* first
- Hardens in 2 to 4 hours

The *E-Wood Paste* in tubes is the easier version with Part A & Part B in a special tube that eliminates the measuring and mixing.

The nozzle that comes with the product is a static mixer that mixes both parts of the paste and it comes out ready to apply with no additional mixing necessary. The nozzle applicator makes it easy to reach into small cracks and crevices that may be difficult to reach with a spatula or putty knife.

Once you have applied what you need, just remove the nozzle and replace the sealing cap that comes on the tube and save the unused product for the next time you need it.

Surface Preparation:
Should be applied after using *M-Balm*. No waiting is necessary.

Application Rates:
1.8 cubic inches per ounce mixed A & B components.

Application Temperature:
40° F to 90° F

Application Methods:
Press into voids using gloved hands.

of Coats:
Tool and texture within 30 minutes of application.

Drying Time:
Hardens in 2 to 4 hours depending on temperature.

Clean up:
Uncured mixed *E-Wood Paste* (Part A and Part B) may be cleaned up with white vinegar then flushed with water.

Packaging:
One 8-oz tube with nozzle
2-component 32 oz. package.
2-component 2-gallon package.

Storage/Shelf Life:
Freeze/thaw stable.
1 year.



Epoxy is the perfect wood filler for permanent patching and repairs of rotting logs, rails, window sills, damaged door jambs, and wood trims that are difficult to remove and expensive to replace.



Remove any loose or decayed wood, and brush away any debris. For best results, apply *Armor-Guard* or *Shell-Guard* borate wood preservative to stop rot. Allow to dry and apply *M-Balm* wood consolidator that helps harden damaged wood.



Mold *E-Wood* epoxy to contour the shape of the rail.

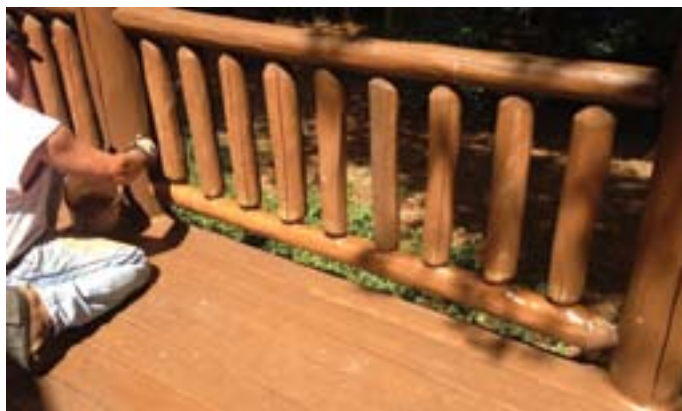

Allow *E-Wood* to cure before staining.

Fasteners

Interior & Exterior



Log Boss™

Fasteners for Log Homes

Log Boss is the fastener with maximum holding power and superior strength. *Log Boss* is specifically designed for log and timber structures.

The 3" long thread provides the grip necessary for pulling even the most difficult logs into place while the larger shank diameter increases the overall strength and pulling power.



Features:

- No pre-drilling required
- No washer needed. Drive it one time and forget it!
- Flat head design easily counter-sinks with maximum pulling power
- The wing reduces torque required to drive the screw
- Coated for minimum friction and corrosion protection
- Made in the USA



Length available:

6", 7", 8", 9", 10", 11", 12", 13", 14", 15", 16"

(Call for information about other available lengths)

Packages includes one 5/16" hex head driver.

Wing Advantages

The wings clear out the splinters created by the thread as the fastener pulls down into the wood.

We also offer a complete line of wood-to-wood code approved fasteners for decks, ledgerboards, and large timber applications.

Blaster Buddy™

Finish Removal System

- Requires an industrial size air compressor (at least 125 cfm at 90 psi)
- Comes with 50 feet of hose, safety line and personal protection equipment
- Available for purchase or rent

New Age Blast Media, made from recycled glass, is available in 50lb bags and covers approx. 75-125 sq. ft. of wood surface.



Osborn™

Buffing Brushes

- Requires a buffer or polisher with 5/8 x 11 NC threads
- Nylon fibers impregnated with *Ultra Grit* abrasive
- Long lasting

Available Sizes:

Cup brush	6" diameter, 80 grit.
Cup brush	6" diameter, 120 grit
Cup brush	4" diameter, 80 grit
Cup brush	4" diameter, 120 grit



Sanding Disks and Holders



A corresponding diameter sanding disk holder is required for use.

Available Sizes:

Available in diameters of 4", 5" and 7" in coarse, medium and fine grit.



Wood Grinding Disks

Available Sizes:

- **Wood Shark**, 4" diameter cup shape, coarse or medium texture.
- **Wood Shark**, 4" diameter dish shape, coarse or medium texture.



- Requires an appropriate size angle grinder for use
- Ideal for removing decayed or unwanted wood
- Long lasting



4" Wood Shark Dish Shape

For Timber Frame Homes

Interior & Exterior

EuroPlast™ & EuroSeal™

Venetian-Style Plaster and Sealer

Looking for just the right complement to enhance the interior walls of your dream home? Consider the ageless appeal of Venetian plaster. For centuries architects, designers, builders, and homeowners alike have marveled at the splendor of this highly popular form of wall surfacing, and throughout the ages, the artisans who were skilled at creating such beauty have been revered and sought after. With today's advanced technology, you can now have this distinctive elegance and appeal at a fraction of the cost, in as little as two days.

Consider this revolutionary approach to dramatic design. *EuroPlast* is a pre-colored, acrylic polymer-based interior and exterior coating system that transforms vertical walls into a classic example of old world Venetian-style plaster. This versatile decorative coating exhibits a rich aesthetic appearance with an unlimited selection of color and texture opportunities. Achieve a wide range of effects from rustic plaster to smooth polished limestone.

EuroPlast is a decorative finish providing color, texture and hard durable surface that resists staining, dirt pick-up, and abuse. Applications easily go over interior and exterior surfaces including stucco, concrete, brick, block, plaster, cement-board sheathings, even primed drywall for interior applications.

EuroSeal is a pure acrylic sealer that is applied over the *EuroPlast* finish. *EuroSeal* has a unique ability to transform newly constructed walls into a classic example of centuries-old plaster. This semi-transparent sealer is formulated to obtain an uneven antiqued, or "mottled," appearance. *EuroSeal* is available in clear or in an unlimited selection of semi-transparent colors. The material can provide a high level of gloss or an eggshell appearance, depending on your design requirements. *EuroSeal* colors are available in pre-tinted containers, ready to apply. The product is intended to create an old world or weathered look while adding a striking characteristic to completed walls.

If this unique product might be that one element to compliment and enhance the beauty of your dream home, contact Stuc-O-Flex International, Inc @ 1-800-305-1045 or visit online www.stucoflex.com



How to Calculate Exterior Sq.Ft.?

It is easier to work up the numbers one wall at a time then add them together. Start by measuring the length of the wall with a tape measure. Then either measure the height or estimate it by counting the number of log courses and multiplying the number of courses by the diameter of the logs.

Just remember that the diameter is in inches so you will need to convert the inches into feet. For example, if the logs are 6-inch diameter logs they are 0.50 feet in diameter and if they are 10 inch logs they are 0.83 feet in diameter.

So if we have a wall that is 25 feet long and has 16 courses of 10 inch diameter logs the calculation is:

$$25 \text{ ft.} \times 16 \text{ courses} \times 0.83 \text{ ft.} = 332 \text{ square feet.}$$

Now, this assumes the wall is flat, but what if the logs are round?

A rule of thumb is to add 25% to the square footage of a wall to compensate for the increased surface area created by the curvature of the logs.

In the above example if the logs are round you would multiply the 332 square feet by 1.25 resulting in 415 square feet of wood surface area.

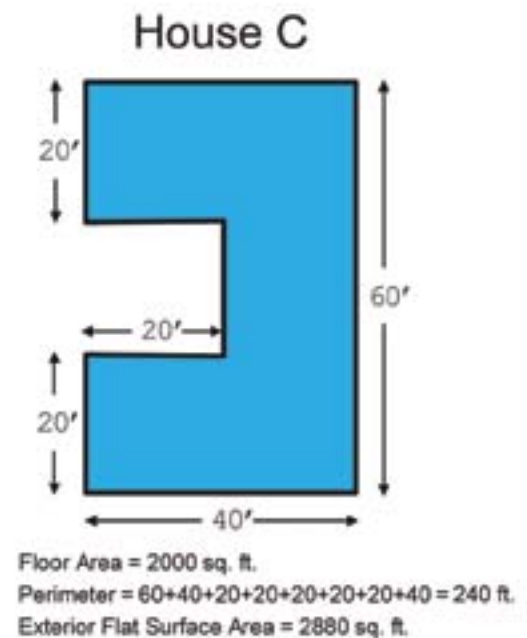
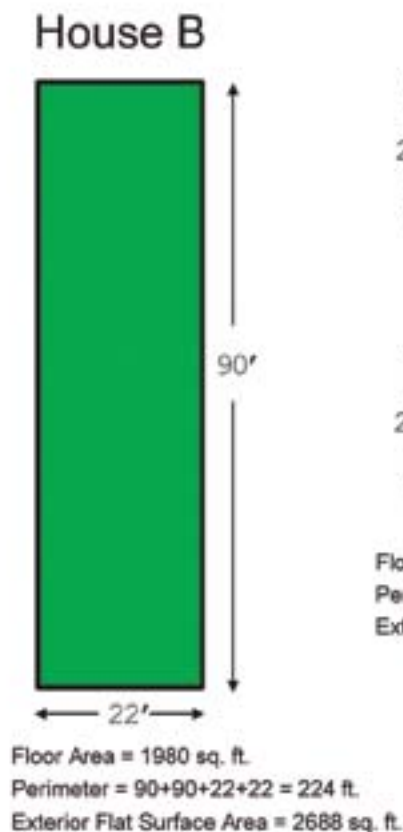
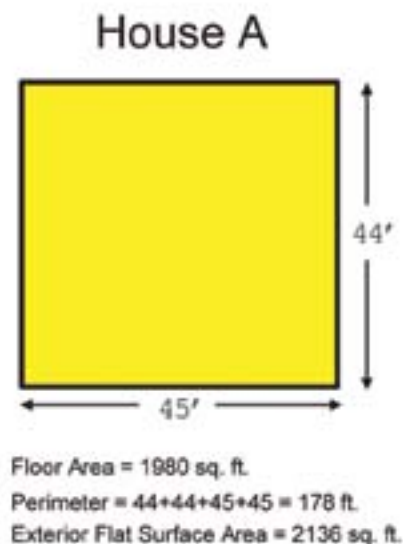

Inspection Checklist

	Wall A	Wall B	Wall C	Wall D	Wall E	Wall F
Are gutters and downspouts clean and working?						
Overall condition of roof and dormers.						
Are shrubs and tree limbs away from the roof, walls, and foundation?						
Sprinklers not hitting the wall?						
Are there signs of finish wear or fading?						
Check eaves and fascia.						
What about the window and door trim?						
Is the foundation in good shape?						
Check plumbing and electrical penetrations.						
Are crawl space vents clear and working properly?						
Are there any signs of leaks around windows?						
Are there cracks, tears or adhesion loss in chinking or caulking?						
Are there any new checks that may need sealing?						
Are there any signs of insect or decay infestations?						
Are the exposed log ends showing signs of water penetration?						
Does the topcoat still look to be intact or is it becoming dull?						
Is the color coat showing signs of fading or darkening?						
Have any discolorations appeared under the finish?						

Draw a Diagram of Your Home Here:

To Find a Log Home Maintenance Contractor
Near You
Visit:
www.permachink.com/general/find-a-contractor
or call 1-800-548-3554

Individual Training Now Available

Using web conference technology, Perma-Chink Systems now offers individual training to homeowners via the internet. You will be able to share documents, photos and other materials with your training Specialist and get answers to your log home and wood care questions in real-time. Call 1-800-548-3554 to schedule an appointment.

Gloss or Satin?

Often we get asked which works better, *Lifeline Advance Gloss* or *Lifeline Advance Satin*? When it comes to performance and longevity there is no doubt about it, a gloss topcoat will outperform a satin topcoat.

Why? The most important factor is reflectivity. A smooth glossy surface reflects more ultraviolet (UV) light than a dull one. That is why automotive finishes do not come in satin versions and why a shiny coat of wax helps retain a vehicle's color.

The next factor is cleanliness. The smooth, slick surface provided by *Lifeline Advance Gloss* sheds dirt easier than the *Satin*. That is because the flattening agent used in the *Lifeline Advance Satin* results in microscopic imperfections in the surface of the finish where airborne dust, pollen, and pollutants can lodge. Although they can be removed with a good washing, it takes a bit more effort than removing dirt from a glossy surface.



Why Finish Interior Walls?

The first obvious answer to this question is because most people want the look of finished wood inside their homes. People typically do not leave plaster or drywall bare and exposed. They cover it with paint or wallpaper. It is the same for a log home. Most people want the interior wood surfaces to look beautiful, not dull and dingy. But an interior wood finish serves other purposes as well.

Bare wood is a great absorber of odors. Cooking, pets, fireplaces and other household activities generate odors that penetrate into bare wood. Pretty soon a log home with interior bare wood walls can begin to smell. However, this odor absorption into the wood can be prevented with the application of an interior finish.

In the past many interior finishes were oil-based (some still are) and, until they are completely dry, the smell of the solvents is almost unbearable. Most quality interior finishes are now water-based but some still have a lingering odor.



Our interior finishes are formulated to be as odorless as possible. That is one advantage we have over many competitive products. Another reason for applying an interior finish is that bare wood is very difficult to keep clean. Dust and dirt get into the nooks and crannies, and the pores of the wood, and become very difficult to remove. A smooth finish helps keep dust from sticking to the wood and makes the surface much easier to keep clean.

Do Checks Need to Be Sealed?

Upward facing checks can collect water increasing the interior moisture content of the log. If they continue to collect water and the wood remains damp, they can eventually result in internal wood decay as well as provide nesting sites for carpenter ants and other insects. It is not necessary to seal checks on the bottom half of round logs since they do not collect water but for a uniform appearance you may want to seal them too. It is not usually necessary

to seal checks or fissures that are less than 1/4" wide since they can not accumulate that much water.

If your home is new and the logs or siding are green, it may be best to wait a year or so before addressing the checks. This allows the wood to reach an equilibrium with its environment and by then most of the larger checks will have opened. On seasoned wood or an older home that

is in the process of being refinished, you can seal the checks either before or after applying a stain.





SATTERWHITE LOG HOMES

Color in this photo closely represents Lifeline Interior Light Natural. Actual results will vary. Contact Perma-Chink Systems for samples.

Payment Terms and Conditions

Forms of Payment:

We accept MASTERCARD, VISA, DISCOVER and AMERICAN EXPRESS. On approved credit, terms are net 30 from date of invoice.

Shipping:

Most orders are shipped within 24 hours. FedEx Home Delivery at no extra charge — including evenings and on Saturdays for many locations.

Terms:

Prices and product availability are subject to change without notice. Seller is not responsible for consequential damages.

All returns require an advance return authorization number (RAN) and will be subject to a 15% restocking charge.

For delivery to your doorstep or additional information contact Perma-Chink Systems, Inc. at the following locations:

Tennessee *Eastern Division:*

1605 Prosser Road, Knoxville, TN 37914
(800) 548-3554

Tennessee, Sevierville

1357 Dolly Parton Parkway, Sevierville, TN 37862
(865) 774-3307

Washington *Western Division:*

17635 N.E. 67th. Ct., Redmond, WA 98052
(800) 548-1231

Montana:

3112 US Highway 93 N, Stevensville, MT 59870
(800) 479-7090

Colorado:

1960 Airport Road, Rifle, CO 81650
(800) 433-8781

Minnesota:

12632 Fromelt Loop NW, Rice, MN 56367
(877) 244-6548

Pennsylvania:

7174 Shavers Creek Road, Petersburg, PA 16669
(800) 257-4864

SHOP ONLINE 24/7



Visit Us Online to Find Dealers and Distributors Near You.

Looking for a PRO?



When it comes to caring for your log home, it is reassuring to know that you can choose a contractor you can rely on for good advice and trust that they are dedicated to providing you with the best results possible.

Our network of independent professional log home contractors stand ready to assist you.

Log-in to our website and click on *Find a Contractor* link to locate a log home restoration and maintenance contractor near you. Or give us a call 1-800-548-3554



1-800-548-3554

www.permachink.com

Be a part of our
LOYAL CUSTOMER PROGRAM



✓ Appearance ✓ Longevity ✓ Value ✓ Environment

PERMA-CHINK[®]
SYSTEMS, INC.

www.permachink.com

1-800-548-3554



LOG & TIMBER HOMES LOOK BEST WITH **LIFELINE[™]**

Rev 4/19



PRESERVING THE LEGACY FOR GENERATIONS

Buy From Perma-Chink Systems

The Best Performing Family of Products!

Check out Monthly Specials and Workshop Schedule online